

- This product is for household use only.**
- # SAVE THESE INSTRUCTIONS.
- Always operate blender with cover in place.
  - When blending hot liquids, remove center piece of two-piece cover.
  - Blades are sharp. Handle carefully.
  - Blender is not running.
  - Reduce the risk of injury to persons or damage to the blender. A scraper may be used, but must be used only when the risk of severe injury to persons or damage to the blender hands and utensils out of container while blending to keep hands and utensils out of container while blending to reduce the risk of injury, never place cutter-assembly blades on base without jar properly attached.
  - To reduce the risk of injury, never place cutter-assembly blades on base without jar properly attached.
  - To reduce the risk of injury, never place cutter-assembly blades on base without jar properly attached.

- Do not let cord hang over edge of table or counter.
  - Do not use outdoors.
  - Do not let cord hang over edge of table or counter.
  - The use of attachments, including canning jars, not recommended by the manufacturer may cause fire, electric shock or injury.
  - The use of attachments, including canning jars, not recommended by the manufacturer may cause fire, electric shock or injury.
  - The longer cord should be arranged so that it will not drape over the counter-top or tabletop where it can be pulled on by children or tripped over.
  - If the power supply cord is damaged, it should be replaced by qualified personnel; in Latin America, by an authorized service center.
- 1) The marked electrical rating of the detachable power-supply cord or extension cord should be at least as great as the electrical rating of the appliance.
  - 2) If the appliance is of the grounded type, the extension cord should be a grounding-type 3-wire cord, and the longer cord should be arranged so that it will not drape over the counter-top or tabletop where it can be pulled on by children or tripped over.
  - 3) The longer cord should be arranged so that it will not drape over the counter-top or tabletop where it can be pulled on by children or tripped over.
- Note:** If the power supply cord is damaged, it should be replaced by qualified personnel; in Latin America, by an authorized service center.
- a) A short power-supply cord (or detachable power-supply cord) is to be provided to reduce the risk resulting from becoming entangled in or tripping over a longer cord.
  - b) Longer detachable power-supply cords or extension cords are available after the appliance malfunctions, or is dropped or damaged in any manner. Return appliance to the nearest authorized service facility or call the appropriate toll-free number on the front of this manual for examination, repair or electrical or mechanical adjustment. Or, call the appropriate toll-free number on the cover of this manual.
  - The use of attachments, including canning jars, not recommended by the manufacturer may cause fire, electric shock or injury.
  - Do not operate any appliance with a damaged cord or plug or after the appliance malfunctions, or is dropped or damaged in any manner. Return appliance to the nearest authorized service facility or call the appropriate toll-free number on the front of this manual for examination, repair or electrical or mechanical adjustment. Or, call the appropriate toll-free number on the cover of this manual.
  - Do not operate any appliance with a damaged cord or plug or after the appliance malfunctions, or is dropped or damaged in any manner. Return appliance to the nearest authorized service facility or call the appropriate toll-free number on the front of this manual for examination, repair or electrical or mechanical adjustment. Or, call the appropriate toll-free number on the cover of this manual.
  - To protect against risk of electrical shock do not immerse cord, plugs or appliance in water or other liquid.
  - Close supervision is necessary when any appliance is used by or unplugged from outlet when not in use, before putting on or taking off parts, and before cleaning.
  - Avoid contacting moving parts.
  - Do not operate any appliance with a damaged cord or plug or after the appliance malfunctions, or is dropped or damaged in any manner. Return appliance to the nearest authorized service facility or call the appropriate toll-free number on the front of this manual for examination, repair or electrical or mechanical adjustment. Or, call the appropriate toll-free number on the cover of this manual.
  - Read all instructions.
  - Always be followed, including the following:
    - When using electrical appliances, basic safety precautions should always be followed, including the following:

## IMPORTANT SAFEGUARDS

Please Read and Save this Use and Care Book.



# CRUSH MASTER® 450-WATT BLENDER LICUADORA CRUSH MASTER® DE 450 WATTS

### Customer Care Line:

USA/Canada  
1-800-231-9786

Mexico  
01-800-714-2503

**Accessories/Parts**  
(USA / Canada)  
**Accesorios/Partes**  
(EE.UU / Canadá)

1-800-738-0245

For **online customer service** and to **register** your product, go to **www.prodprotect.com/applica**

### MODELS/MODELO

- BL10450H
- BL10450HB
- BL10450HR

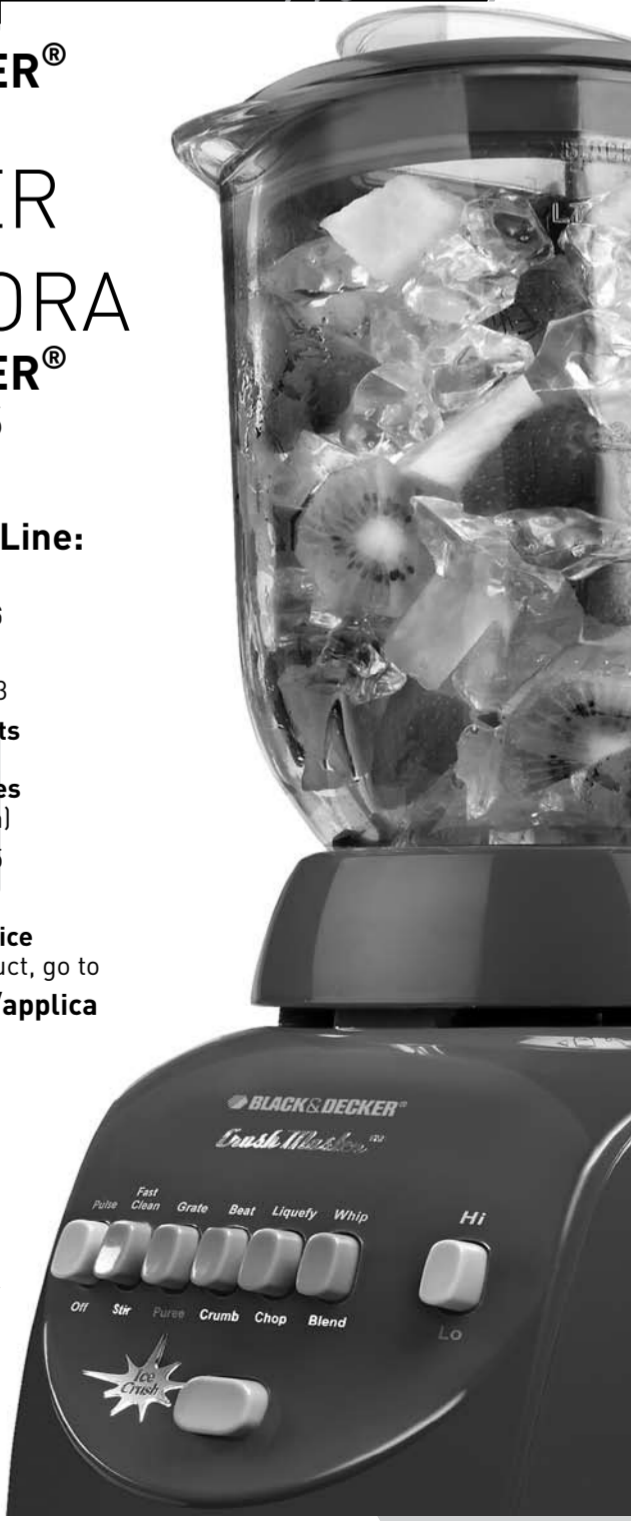

- POLARIZED PLUG (120V Models Only)**
- This appliance has a polarized plug (one blade is wider than the other). To reduce the risk of electric shock, this plug is intended to fit into a polarized outlet only one way. If the plug does not fit fully into the outlet, reverse the plug. If it still does not fit, contact a qualified electrician. Do not attempt to modify the plug in any way.
- TAMPER-RESISTANT SCREW**
- Warning:** This appliance is equipped with a tamper-resistant screw to prevent removal of the outer cover. To reduce the risk of fire or electric shock, do not attempt to remove the outer cover. There are no user-serviceable parts inside. Repair should be done only by authorized service personnel.
- ELECTRICAL CORD**
- a) A short power-supply cord (or detachable power-supply cord) is to be provided to reduce the risk resulting from becoming entangled in or tripping over a longer cord.
  - b) Longer detachable power-supply cords or extension cords are available after the appliance malfunctions, or is dropped or damaged in any manner. Return appliance to the nearest authorized service facility or call the appropriate toll-free number on the front of this manual for examination, repair or electrical or mechanical adjustment. Or, call the appropriate toll-free number on the cover of this manual.
  - The use of attachments, including canning jars, not recommended by the manufacturer may cause fire, electric shock or injury.
  - Do not use outdoors.
  - Do not let cord hang over edge of table or counter.
  - To reduce the risk of injury, never place cutter-assembly blades on base without jar properly attached.
  - To reduce the risk of injury, never place cutter-assembly blades on base without jar properly attached.
  - Always operate blender with cover in place.
  - When blending hot liquids, remove center piece of two-piece cover.

**Warning:** This appliance is equipped with a tamper-resistant screw to prevent removal of the outer cover. To reduce the risk of fire or electric shock, do not attempt to remove the outer cover. There are no user-serviceable parts inside. Repair should be done only by authorized service personnel.

**ELECTRICAL CORD**

- 1) The marked electrical rating of the detachable power-supply cord or extension cord should be at least as great as the electrical rating of the appliance.
- 2) If the appliance is of the grounded type, the extension cord should be a grounding-type 3-wire cord, and the longer cord should be arranged so that it will not drape over the counter-top or tabletop where it can be pulled on by children or tripped over.
- 3) The longer cord should be arranged so that it will not drape over the counter-top or tabletop where it can be pulled on by children or tripped over.

**Note:** If the power supply cord is damaged, it should be replaced by qualified personnel; in Latin America, by an authorized service center.

#### How does state law relate to this warranty?

- This warranty gives you specific legal rights. You may also have other rights that vary from state to state or province to province.

**BLACK & DECKER** is a registered trademark of The Black & Decker Corporation, Towson, Maryland, USA

es una marca registrada de The Black & Decker Corporation, Towson, Maryland, E.U.

Sello del Distribuidor:	<p><b>Comercializado por:</b>          Applica Manufacturing, S. de R. L. de C.V.          Presidente Mazarik No 111, 1er Piso          Col. Chapultepec Morales, Mexico D.F          Deleg. Miguel Hidalgo          CP 11570          MEXICO</p> <p><b>Servicio y Reparación</b>          Art. 123 No. 95          Col. Centro, C.P. 06050          Deleg. Cuauhtemoc</p> <p><b>Servicio al Consumidor,</b>          Venta de Refacciones y Accesorios          01 800 714 2503</p>
Fecha de compra:	
Modelo:	

**450 W 120 V~ 60 Hz**

**Código de fecha / Date Code**



© 2009 - 2010 Applica Consumer Products, Inc.

Made in People's Republic of China  
 Printed in People's Republic of China  
 Fabricado en la República Popular de China  
 Impreso en la República Popular de China

#### Importado por / Imported by:

**APPLICA AMERICAS, INC.**  
 Av. Juan B Justo 637 Piso 10  
 [C1425FSA] Ciudad Autonoma de Buenos Aires  
 Argentina  
**C.U.I.T No.** 30-69729892-0

#### Importado por / Imported by:

**APPLICA MANUFACTURING, S. DE R. L. DE C. V.**  
 Presidente Mazarik No111, 1er Piso  
 Col. Chapultepec Morales, Mexico D.F  
 Deleg. Miguel Hidalgo  
 CP 11570  
 MEXICO  
 Teléfono: (55) 5263-9900  
**Del interior marque sin costo**  
 01 (800) 714 2503

R12009/4-14-88E/S

- Note:** † indicates consumer replaceable/removable parts
- † 1. Lid cap (Part # 081049)
  - † 2. Lid (Part # 081050DZ102 (W), 081050E2 (B), BL10450HR-02 (R))
  - † 3. Blending glass jar [48 oz. / 1.4 L] (Part # 99002)
  - † 4. Handle
  - † 5. Gasket (Part # 09150)
  - † 6. Blade assembly (Part # 7766)
  - † 7. Jar base  
 (Part # 03474DZ101 (W), 03474EB (B), BL10450HR-06 (R))
  8. Blender base
  9. Control panel (see A2 for details)
  10. Hi/Low Button
  11. ICE CRUSH button
  12. Pulse/Off button
  13. Speed buttons

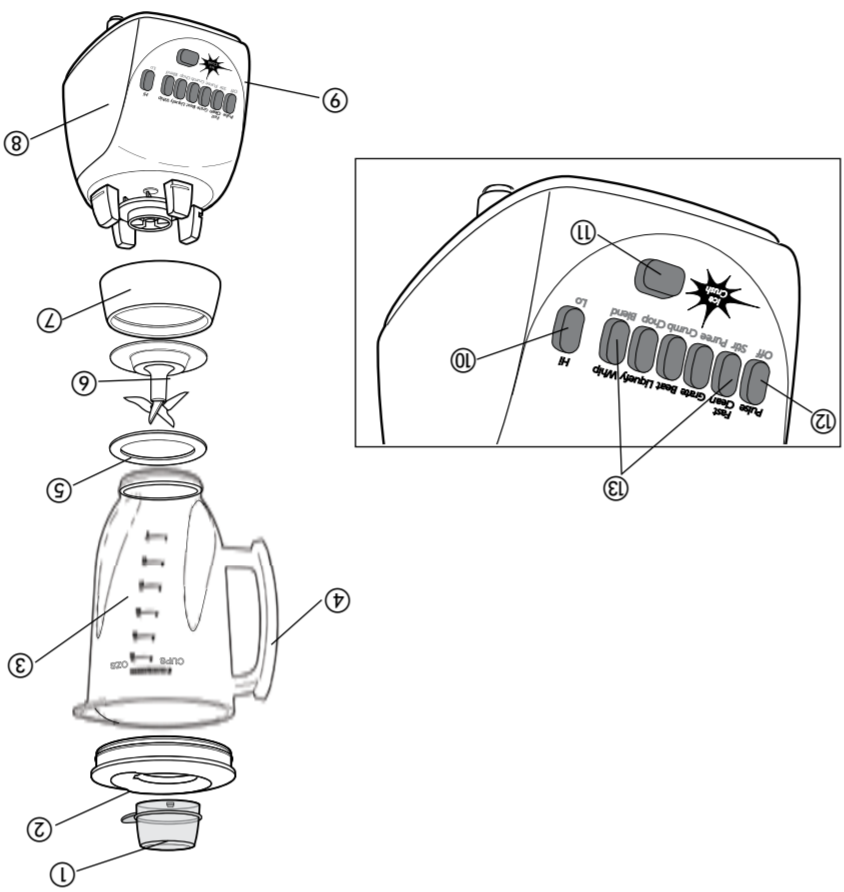

Product may vary slightly from what is illustrated.

## TROUBLESHOOTING

PROBLEM	POSSIBLE CAUSE	SOLUTION
Jar bottom does not come off of jar.	A vacuum has been formed.	Place the jar on the blender and turn counter clockwise until jar is released from the bottom
Liquid is leaking from bottom of jar.	Gasket is either missing or not in place correctly.	Check that jar is assembled correctly.
Appliance does not turn on.	Appliance is not plugged in.	Check that appliance is plugged into a working outlet.
Mixture in blender does not seem to be blending.	Not enough liquid in mixture being blended or too much ice.	Turn the blender off and use a rubber spatula to redistribute the food; add some liquid and PULSE the mixture to aid in the blending process.
Herbs or bread are sticking to sides of blender and not getting chopped.	Blender jar, food to be chopped or blade are not dry.	Always make sure that the jar, the blade and the food to be chopped are dry.
Jar separates from bottom when being removed from blender. Liquid spills onto counter.	Jar was twisted when being removed from base of blender.	When removing jar from blender base, simply lift up; do not twist.
Food chopped is too fine or watery.	Food is over processed.	Use PULSE in short bursts or blend for a shorter time.

#### NEED HELP?

For service, repair or any questions regarding your appliance, call the appropriate 800 number on cover of this book. Please **DO NOT** return the product to the place of purchase. Also, please **DO NOT** mail product back to manufacturer, nor bring it to a service center. You may also want to consult the website listed on the cover of this manual.

#### Two-Year Limited Warranty (Applies only in the United States and Canada)

##### What does it cover?

- Any defect in material or workmanship provided; however, Applica's liability will not exceed the purchase price of product.

##### For how long?

- Two years after date of purchase.

##### What will we do to help you?

- Provide you with a reasonably similar replacement product that is either new or factory refurbished.

#### How do you get service?

- Save your receipt as proof of date of sale.
- Visit the online service website at [www.prodprotect.com/applica](http://www.prodprotect.com/applica), or call toll-free 1-800-231-9786, for general warranty service.
- If you need parts or accessories, please call 1-800-738-0245.

#### What does your warranty not cover?

- Damage from commercial use
- Damage from misuse, abuse or neglect
- Products that have been modified in any way
- Products used or serviced outside the country of purchase
- Glass parts and other accessory items that are packed with the unit
- Shipping and handling costs associated with the replacement of the unit
- Consequential or incidental damages (Please note, however, that some states do not allow the exclusion or limitation of consequential or incidental damages, so this limitation may not apply to you.)

- Tip:** Use the lid cap to measure ingredients up to 60 ml / 2 oz. when adding ingredients like lemon juice, cream, or liquors.
1. To crush ice, pour liquid in blending jar first, then add 1 cup (about 6 cubes).
  2. Hold one hand firmly on lid and pulse, using the Ice Crush button (press Ice Crush button at 5-second intervals).

#### ICE CRUSH BUTTON

11. Always unplug the appliance when not in use.
  10. Remove lid to pour.
  9. To remove the jar, grasp the handle, turn slightly counterclockwise to unlock, stopped before attempting to remove the blending jar from the base.
  8. When finished, press the Pulse/Off button. Make sure blades have completely stopped before attempting to remove the blending jar from the base.
- Important: Do not remove the lid while the blender is running.**
7. Open the lid cap to add ingredients while the blender is running and drop ingredients through the opening.
  6. When blending thick mixtures, such as smoothies, power drinks and milkshakes press the Pulse button several times to begin the blending process. Press the Pulse button for no more than 5 seconds at a time. This helps break up the ice.
  5. Select the speed that best suits your desired task. Press Hi/Low with the task place.

**Note:** When in use, do not leave blender unattended. When using hard foods, such as ice, cheese, nuts and coffee beans, keep one hand on the lid to keep blender in place.

4. Plug power cord into outlet.
3. Place lid on jar; make sure lid cap is in place.
2. Place foods to be blended into jar.
1. Make sure appliance is OFF.

#### USING YOUR BLENDER

9. Blender is now ready for use.
8. Place jar assembly in unlocked position on base and turn jar clockwise until jar is in the locked position.
7. Uncoil power cord from storage area under the base.
6. Place lid with lid cap onto blending jar.
5. Turn assembled jar right side up.
4. Place jar base onto jar and rotate clockwise until it is tight.
3. Place blade assembly with gasket into bottom opening of the jar with blades facing down.
2. Put gasket on top of blade assembly.
1. Turn blending jar upside down and place flat on countertop or work surface.

#### BLENDER JAR ASSEMBLY

- Wipe outside of appliance with a damp cloth; dry thoroughly.
- Wash all removable parts as instructed in CARE AND CLEANING section of this manual.
- Please go to [www.prodprotect.com/applica](http://www.prodprotect.com/applica) to register your warranty.
- Remove all packing material and any stickers from the product.

#### GETTING STARTED

This unit is for household use only.

## How to Use

## Care and Cleaning

This product contains no user serviceable parts. Refer service to qualified service personnel.

#### CLEANING

1. Before cleaning, turn off and unplug appliance.
2. Lift blending jar by handle off power base.
3. Remove jar base by turning counterclockwise until loose.
4. Remove gasket and blade assembly.

#### Caution: Blades are sharp, handle carefully.

5. Remove lid and lid cap.
6. Wash removable parts by hand or in your dishwasher. Place jar on bottom rack and rest of parts on top-rack only.

#### FAST CLEAN

For quick cleanup, combine 1 cup hot water and a drop of liquid dish soap in the blending jar. Cover and blend on Fast Clean for about 30 seconds. Discard liquid and rinse jar thoroughly.

#### Important:

- **Do not place jar parts in boiling liquids.**
- **Do not immerse base in liquid. Wipe base with damp cloth and dry thoroughly.**
- **Remove stubborn spots by rubbing with damp cloth and nonabrasive cleaner.**

**Note:** If liquids spill onto base, wipe with damp cloth and dry thoroughly. Do not use rough scouring pads or cleansers on parts or finish.

#### STORAGE

For convenient storage, wrap the cord around the feet on the bottom of the blender base.

SPEED CHART
<b>Pulse/Off:</b> Use for thick mixtures
<b>Fast Clean:</b> Combine drop of dishwashing liquid and hot water to clean blender
<b>Stir:</b> Liquefy frozen juices, drink mixes and condensed soups • Prepare salad dressings • Puree hot liquids
<b>Grate:</b> Grate hard cheeses and coconut • Make superfine sugar • Make cookie, cereal and bread crumbs • Grind coffee beans, spices and chocolate
<b>Puree:</b> Blend protein drinks • Puree baby foods – fruits and vegetables
<b>Beat:</b> Beat eggs for omelets and custards
<b>Crumb:</b> Make cookie, cereal and bread crumbs
<b>Liquefy:</b> Liquefy frozen drinks
<b>Chop:</b> Chop fruits and vegetables • Chop cooked meats • Chop nuts, coarse-to-fine
<b>Whip:</b> Mix puddings • Combine pancake and waffle batter or mixes • Beat eggs for omelets and custards
<b>Blend:</b> Prepare sauces • Remove lumps from gravies
<b>HI/LOW:</b> Select to change speed between Hi and Low • Hi – the button is out • Low – the button is in.

