

Please Read and Save this Use and Care Book.

IMPORTANT SAFEGUARDS

When using electrical appliances, basic safety precautions should always be followed, including the following:

- Read all instructions.
- To protect against risk of electrical shock, do not put blender base, cord, or plug in water or other liquid.
- Close supervision is necessary when any appliance is used by or near children.
- Unplug from outlet when not in use, before putting on or taking off parts, and before cleaning.
- Avoid contacting moving parts.
- Do not operate any appliance with a damaged cord or plug or after the appliance malfunctions or is dropped or damaged in any manner. Return the appliance to the nearest authorized service facility for examination, repair, or electrical or mechanical adjustment. Or, call the appropriate toll-free number listed on the cover of this manual.
- The use of attachments, including canning jars, not recommended or sold by the appliance manufacturer may cause fire, electric shock, or injury.
- Do not use outdoors.
- Do not let the plug or cord hang over the edge of table or counter.
- Keep hands and utensils out of container while blending to reduce the risk of severe injury to persons or damage to the blender. A scraper may be used but must be used only when the blender is not running.
- Blades are sharp. Handle carefully.
- To reduce the risk of injury, never place cutter assembly blades on base without the jar properly attached.
- Always operate blender with cover in place.
- When blending hot liquids, remove center piece of two-piece cover.
- Do not use appliance for other than intended use.

SAVE THESE INSTRUCTIONS.

This product is for household use only.

POLARIZED PLUG (120V Models Only)

This appliance has a polarized plug (one blade is wider than the other). To reduce the risk of electric shock, this plug is intended to fit into a polarized outlet only one way. If the plug does not fit fully into the outlet, reverse the plug. If it still does not fit, contact a qualified electrician. Do not attempt to modify the plug in any way.

TAMPER-RESISTANT SCREW

Warning: This appliance is equipped with a tamper-resistant screw to prevent removal of the outer cover. To reduce the risk of fire or electric shock, do not attempt to remove the outer cover. There are no user-serviceable parts inside. Repair should be done only by authorized service personnel.

ELECTRICAL CORD

The cord of this appliance was selected to reduce the possibility of tangling in or tripping over a longer cord. If more length is needed, use an extension cord rated no less than 15-amperes. (For 220 volts rated products, use an extension cord rated no less than 6-amperes). When using an extension cord, do not let it drape over the working area or dangle where someone could accidentally trip over it. Handle cord carefully for longer life; avoid jerking or straining it at outlet and appliance connections.

Note: If the power supply cord is damaged, it should be replaced by qualified personnel or in Latin America by an authorized service center.

Product may vary slightly from what is illustrated.

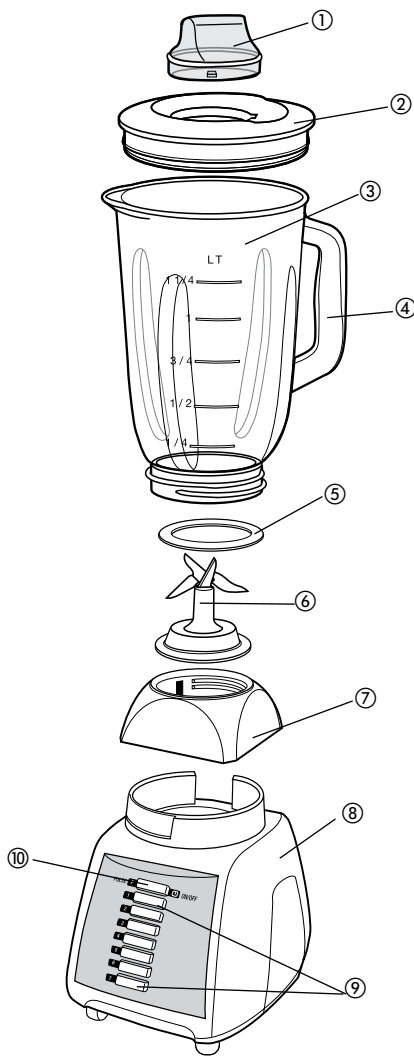

1. Lid cap
2. Lid
3. 42-oz. / 5-cup glass blending jar
4. Handle
5. Gasket
6. Blade assembly
7. Jar base
8. Unit base
9. Speed buttons
10. Pulse (P) and On/Off button

BLENDING TIPS AND TECHNIQUES

- Cut food into small pieces $\frac{3}{4}$ " (2 cm) before adding to the blender.
- When ingredients stick or spatter along the sides of the jar, stop the blending action and remove the lid. Use a rubber spatula to push food toward the blades. Replace the lid, then continue blending.
- Some of the tasks that cannot be performed efficiently with a blender are: beating egg whites, whipping cream, mashing potatoes, mixing dough, and extracting juices from fruits and vegetables.
- The following items should never be placed in the unit as they may cause damage: dried spices and herbs (ground alone), bones, large pieces of solidly frozen foods, tough foods such as turnips.
- Use the lid cap to measure ingredients up to 60 ml (2 oz.) when adding ingredients like lemon juice, cream, or liqueurs.

Care and Cleaning

This product contains no user serviceable parts. Refer service to qualified service personnel.

Important: To maintain performance, dry blades after cleaning.

CLEANING

1. Before cleaning, turn off and unplug the unit. Twist to unlock (↶), lift the jar off the unit base, and rinse. For easier cleanup, rinse parts immediately after blending. Parts may be hand-washed.
2. Do not immerse the base in liquid. Wipe the unit base with a damp cloth and dry thoroughly. Remove stubborn spots by rubbing with a damp cloth and nonabrasive cleaner.

Note: If liquids spill into the base, wipe with a damp cloth and dry thoroughly. Do not use rough scouring pads or cleansers on parts or finish.

3. Removable parts can be washed by hand or in a dishwasher. Lid, lid cap, and blade assembly should be placed in the top rack only. The jar is bottom rack dishwasher-safe. Do not place jar or parts in boiling liquids.

BLACK & DECKER is a registered trademark of The Black & Decker Corporation, Towson, Maryland, USA

BLACK & DECKER es una marca registrada de The Black & Decker Corporation, Towson, Maryland, E.U.

How to Use

This product is for household use only.

BLENDER JAR ASSEMBLY

1. After unpacking the blender, before first use, wash all parts except the unit base.
2. Put the gasket on top of the blade assembly.
3. Place the blade assembly into the jar base and turn the jar base clockwise until tight **(A)**.
4. **Interlock System (220V models only):** Place the assembled jar onto the unit base and turn toward lock (↶) until secured in place. You've engaged the Interlock System if you lift the jar handle and the entire blender lifts together as one unit.



USING YOUR BLENDER

Note: Your unit has a motor overheating protection system that automatically shuts off the motor.

1. Make sure the unit is OFF and plug the cord into a standard electrical outlet.
2. Place the food into the jar and the lid on the jar before blending.
3. Make sure that the lid cap is in place. When crushing hard foods, keep one hand on the lid.
4. Choose the speed that best suits your task for food or beverage blending.
5. When finished blending, press the On/Off button.

6. For quick or delicate blending tasks use the Pulse (P) button for a few seconds, then release **(B)**. Releasing the Pulse (P) button automatically turns off the blender.
7. To add ingredients while the blender is on, remove the lid cap and drop ingredients through the lid opening.



8. To remove the jar, grasp the handle, twist toward the unlock (↷) and lift it from the unit base.

9. Remove the lid before pouring.

Por favor llame al número correspondiente que aparece en la lista a continuación para solicitar que se haga efectiva la garantía y donde Ud. puede solicitar servicio, reparaciones o partes en el país donde el producto fué comprado. También puede consultarnos en el e-mail servicio@applicamail.com.mx

Argentina
SERVICIO TECNICO CENTRAL
ATTENDANCE
Avda. Monroe N° 3351
Buenos Aires – Argentina
Fonos: 0810 – 999 - 8999
011 - 4545 - 4700
011 – 4545 – 5574
supervision@attendance.com.ar

Chile
MASTER SERVICE SERVICENTER
Nueva Los Leones N° 0252
Providencia
Santiago – Chile
Fono Servicio: [562] – 232 77 22
servicente@servicenter.cl

Colombia
PLINARES
Avenida Quito # 88A-09
Bogotá, Colombia
Tel. sin costo 01 800
7001870

Costa Rica
Aplicaciones Electromecánicas, S.A.
Calle 26 Bis y Ave. 3
San Jose, Costa Rica
Tel.: [506] 257-5716 / 223-0136

Ecuador
Servicio Master de Ecuador
Av. 6 de Diciembre 9276 y los Alamos
Tel. [593] 2281-3882

El Salvador
Calle San Antonio Abad 2936
San Salvador, El Salvador
Tel. [503] 2284-8374

Guatemala
MacPartes SA
3ª Calle 414 Zona 9
Frente a Tecun
Tel. [502] 2331-5020 / 2332-2101

Honduras
ServiTotal
Contigua a Telecentro
Tegucigalpa, Honduras,
Tel. [504] 235-6271

México
Artículo 123 # 95 Local 109 y 112
Col. Centro, Cuauhtemoc,
México, D.F.
Tel. 01 800 714 2503

Nicaragua
ServiTotal
De semáforo de portezuelo
500 metros al sur.
Managua, Nicaragua,
Tel. [505] 248-7001

Panamá
Servicios Técnicos CAPRI
Tumbamuerto Boulevard
El Dorado Panamá
500 metros al sur.
Tel. 3020-480-800 sin costo
[507] 2360-236 / 159

Perú
Servicio Central Fast Service
Av. Angamos Este 2431
San Borja, Lima Perú
Tel. [511] 2251 388

Puerto Rico
Buckeye Service
Jesús P. Piñero #1013
Puerto Nuevo, SJ PR 00920
Tel.: [787] 782-6175

Republica Dominicana
Plaza Lama, S.A.
Av. Duarte #94
Santo Domingo,
República Dominicana
Tel.: [809] 687-9171

Venezuela
Inversiones BDR CA
Av. Casanova C.C.
City Market Nivel Plaza Local 153
Diagonal Hotel Melia,
Caracas.
Tel. [582] 324-0969

www.applicaservice.com
servicio@applicamail.com