

OWNER'S MANUAL

Model No. GR72

GEORGE FOREMAN™

OPEN HEARTH ELECTRIC GRILL



**salton®**

IMPORTANT SAFEGUARDS

When using electrical appliances, basic safety precautions should always be followed to reduce the risk of fire, electric shock and injury to persons, including the following:

1. Read all instructions before using appliance.
2. Do not touch hot surfaces. Use handles or knobs and oven mitts or pot holders.
3. To protect against electric shock do not immerse cord, plug, or the Temperature Control Probe in water or other liquid.
4. Close supervision is necessary when any appliance is used near children.
5. This appliance is not for use by children.
6. Unplug from outlet when not in use and before cleaning. Allow to cool before putting on or taking off parts, and before cleaning the appliance.
7. Do not operate any appliance with a damaged cord or plug or after the appliance malfunctions, or has been dropped or damaged in any manner. Contact consumer service for return authorization, examination, repair or adjustment.
8. The use of accessory attachments not recommended by the appliance manufacturer may cause injuries.
9. Do not use outdoors or while stand in a damp area.
10. Do not let cord hang over edge of table or counter, or touch hot surfaces.
11. Do not place on or near a hot gas or electric burner, or in a heated oven.
12. To disconnect, turn the Temperature Control Knob to "OFF", grasp plug and remove from wall outlet.
13. Extreme caution must be used when moving an appliance containing hot oil or other hot liquids. Allow liquid to cool before removing and emptying drip tray.
14. Do not attempt to dislodge food or clean the grill when it is plugged in or when it is hot.
15. Fuel, such as charcoal briquettes, is not to be used with this appliance.
16. Do not operate the Grill without the Grill Base and Drip Tray in place.
17. Do not use this appliance for other than its intended use.

SAVE THESE INSTRUCTIONS

THIS APPLIANCE IS FOR HOUSEHOLD USE ONLY.

Additional Important Safeguards

1. ***CAUTION - HOT SURFACES: This appliance generates heat and escaping steam during use. Proper precautions must be taken to prevent the risk of burns, fires or other damage to persons or property.***
2. All users of this appliance must read and understand this Owner's Manual before operating or cleaning this appliance.
3. The cord to this appliance should be plugged into a 120V AC electrical outlet only.
4. Do not use the Temperature Control Probe with any other appliance.
5. When using this appliance, provide adequate air space above and on all sides for air circulation. Do not allow this appliance to touch curtains, wall coverings, clothing, dish towels or other flammable materials during use. Do not use on surfaces where heat may be a problem.
6. Do not leave this appliance unattended during use.
7. If this appliance begins to malfunction during use, immediately unplug cord from outlet. Do not use or attempt to repair the malfunctioning appliance.
8. **Use caution while placing or removing food on cooking surface to prevent accidental injury.**

Polarized Plug

This appliance has a **polarized plug** (one blade is wider than the other). To reduce the risk of electric shock, this plug is intended to fit in a polarized outlet only one way. If the plug does not fit fully in the outlet, reverse the plug. If it still does not fit, contact a qualified electrician. Do not attempt to modify the plug in any way.

Short Cord Instructions

A short power-supply cord is provided to reduce the risk resulting from becoming entangled in or tripping over a longer cord. Extension cords are available and may be used if care is exercised in their use.

If an extension cord is used, (1) the marked electrical rating of the extension cord should be at least as great as the electrical rating of the appliance, and (2) the longer cord should be arranged so that it will not drape over the counter top or table top where it can be pulled on by children or tripped over unintentionally.

Electric Power

If the electric circuit is overloaded with other appliances, your appliance may not operate properly. It should be operated on a separate electrical circuit from other appliances.

CAUTION: To prevent Plasticizers to migrate from the finish of the counter top or table top or other furniture, place **NON-PLASTIC** coasters or placemats between the appliance and the finish of the counter top or table top.

Failure to do so may cause the finish to darken, permanent blemishes may occur or stains can appear.

Temperature Control Probe

Use only the Temperature Control Probe (P/N 22003) supplied with this product. Using any other type of Temperature Control Probe may cause fire, electric shock, or injury.

The Temperature Control Probe is designed to yield precise results. Use care not to drop, hit, or impact it against hard surfaces. Dropping or banging it could change its calibration and make the temperature settings inaccurate.

Never pull on the cord of the Temperature Control Probe. Always grip the body of the Temperature Control Probe when handling.

NOTE: The Temperature Control Probe is not immersible.

Getting To Know Your GR72 Open Hearth Grill

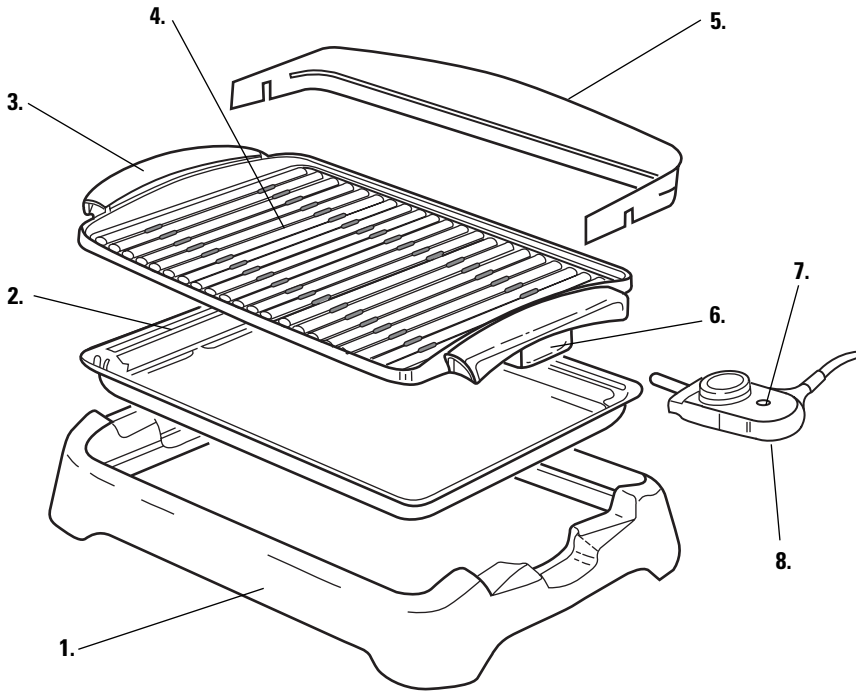

1. Grill Base (P/N 21999)
2. Removable Drip Tray (P/N 22000)
3. Cool Touch Handle
4. Non-Stick Grill Plate (P/N 22001)
5. Splatter Guard (P/N 22002)
6. Probe Receptacle
7. Thermostat Light
8. Temperature Control Probe (P/N 22003)

Introduction

Congratulations on the purchase of your George Foreman™ Open Hearth Grill. You can now enjoy delicious, healthy barbecued meals in minutes.

Compact and versatile, the Open Hearth Grill is lightweight and easy to use.

Features

Non-stick cooking surface

Coats the entire Grill Plate for reduced fat cooking and easy cleaning.

Grill Plate

Sears in the juices and flavors of your favorite foods, and allows fats to drip through the grill bars for healthy, fat free cooking.

Detachable splatter guard

Prevents fats and juices from splashing onto work surface.

Heat settings

Variable heat settings provide perfect control in a multitude of cooking tasks.

Temperature Control Probe

The Temperature Control Probe is thermostatically controlled to ensure constant temperature, and is removable for portability and easy cleaning.

Removable Drip Tray

Collects fats and juices during cooking. Dishwasher safe for easy cleaning.

Grill Base

Supports the Grill Plate and Drip Tray. Made from durable heat resistant Nylon.

How To Use the George Foreman Open Hearth Grill

WARNING: Charcoal or similar combustible fuels must not be used with this appliance.

1. Before using the Grill for the first time, remove the protective film from the Grill Plate. Wash the Drip Tray and Grill Plate in warm soapy water. See *User Maintenance Instructions*.
2. Place the Drip Tray into the Grill Base.
3. Place the Grill Plate on the Drip Tray.

NOTE: Drip Tray and Grill Base MUST always be in place when using the Grill.

4. Attach the Splatter Guard to the Grill by positioning the Splatter Guard on the Grill Plate so that the slots in the Guard are resting securely over the ribs at either end of the Grill Plate, as shown in Figure 1. The Splatter Guard simply lifts off for easy cleaning and storage.

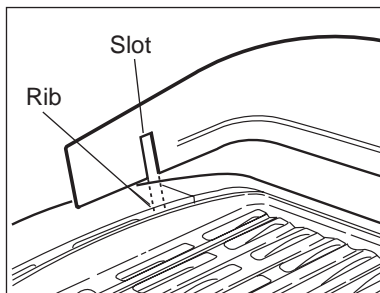

Figure 1

5. Turn the Temperature Control Probe to "OFF", insert it fully into the receptacle on the Grill Plate. Plug the cord into a 120V AC electrical outlet.
6. **To preheat:** Turn the Temperature Control Probe dial to the desired heat setting, or the heat setting recommended in the recipe/Grilling Chart. The Thermostat Light will illuminate. **Note:** The Thermostat Light on the Temperature Control Probe indicates the Grill is heating. The light will remain ON until the set temperature has been reached and then will cycle ON and OFF as needed to maintain the set temperature.
7. Allow the Grill to preheat except where noted on the Grilling Chart. The preheat time will depend on the heat setting selected. If a high heat setting is selected, a longer preheat time is required.
8. Carefully place the items to be cooked on the Grill Plate and allow the food to cook until done. (Consult the Recipe Section/Grilling Chart in this book.) **Do not leave Grill unattended during use!**
9. When finished cooking, turn the Temperature Control Probe to "OFF". Disconnect the plug from the wall outlet and let the Grill cool completely.
10. Remove the food using a heat resistant plastic or wooden utensil. Be sure to always use either plastic or wooden utensils so as not to scratch the non-stick surface. Never use metal tongs, forks or knives as these can damage the coating on the Grill Plate.
11. When cool, the Drip Tray may be removed and emptied. **Be sure the liquid has cooled before removing Drip Tray.**

Grilling Hints and Tips

- Use tender cuts of meat for grilling.
- Marinate tougher cuts of meat to tenderize them before grilling.
- To avoid drying out meat and fish, do not pierce with a utensil.
- Adjust heat setting gradually and only as necessary. Cooking foods at too high a temperature can cause them to dry out.
- Better cooking results will be achieved with boneless cuts of meat, chicken and fish.
- Cut the edge of the meat in several places to prevent curling of the meat.
- If grilling more than one item, select foods of even thickness. This will promote consistent doneness and appearance.
- For grilling small portions, make sure meat is centered on Grill. When grilling larger portions, distribute evenly and allow one inch space between foods to promote uniform cooking.
- When grilling fish or chicken breast fillets, tuck extremely thin parts under to prevent overcooking.
- If food is under-cooked when removed from Grill, simply return to Grill for additional cooking time.

User Maintenance Instructions

WARNING: To avoid electric shock, unplug from outlet when not in use and before cleaning. Use care not to fully submerge Probe Receptacle during cleaning.

CAUTION: To avoid accidental burns, allow your Grill to cool thoroughly before cleaning.

1. Before cleaning, turn the Temperature Control Probe to "OFF", unplug it from the wall outlet and then remove it from the Grill Plate Receptacle. Allow the Grill to cool completely.
2. **Cleaning Grill Plate, Drip Tray and Splatter Guard:** Wipe the Grill Plate with an absorbent paper towel or a sponge. Runoff will drip into the Drip Tray. Remove the Splatter Guard and Grill Plate. Empty the Drip Tray into an appropriate container. Wash the Grill Plate, Drip Tray and Splatter Guard with warm soapy water but use care not to fully submerge the end of the Grill Plate which houses the Probe Receptacle. Rinse and dry thoroughly. Do not wash the Grill Plate in the dishwasher.
Important: Always make sure the Probe Receptacle is completely dry before reinserting the Temperature Control Probe.
3. **Stubborn build-up:** If necessary, use a non-metallic scrubbing pad to clean the Grill Plate and a stiff, non-metallic brush to clean between the grill bars. Do not use steel wool, scouring pads, or abrasive cleaners on any part of the Grill.
4. **Cleaning Temperature Control Probe:** If necessary, wipe with a damp cloth and dry thoroughly. **Do not immerse the Cord, Plug or Temperature Control Probe in water or any other liquid!**
5. **Cleaning Grill Base:** Wipe with a damp cloth or wash with warm, soapy water. Rinse and dry. **Do not wash the Grill Base in the dishwasher.**
6. Any servicing requiring disassembly other than the above cleaning must be performed by a qualified appliance repair technician.

LIMITED ONE YEAR WARRANTY

Warranty: This George Foreman™ product is warranted by Salton, Inc. to be free from defects in materials or workmanship for a period of (1) year from the original purchase date. This product warranty covers only the original consumer purchaser of the product.

Warranty Coverage: This warranty is void if the product has been damaged by accident in shipment, unreasonable use, misuse, neglect, improper service, commercial use, repairs by unauthorized personnel, normal wear and tear, improper assembly, installation or maintenance abuse or other causes not arising out of defects in materials or workmanship. This warranty is effective only if the product is purchased and operated in the USA, and does not extend to any units which have been used in violation of written instructions furnished with the product or to units which have been altered or modified or to damage to products or parts thereof which have had the serial number removed, altered, defaced or rendered illegible.

Implied Warranties: ANY IMPLIED WARRANTIES WHICH THE PURCHASER MAY HAVE ARE LIMITED IN DURATION TO ONE (1) YEAR FROM THE DATE OF PURCHASE. Some states do not allow limitations on how long an implied warranty lasts, so the above limitation may not apply to you.

Warranty Performance: During the above one-year warranty period, a product with a defect will be either repaired or replaced with a reconditioned comparable model (at our option) when the product is returned to the Repair Center, or the purchase price refunded. The repaired or replacement product will be in warranty for the balance of the one-year warranty period and an additional one-month period. No charge will be made for such repair or replacement.

Service and Repair: Should the appliance malfunction, you should first call toll-free 1 (800) 937-3883 between the hours of 9:00 am and 5:00 pm Central Standard Time and ask for CONSUMER SERVICE stating that you are a consumer with a problem. Please refer to model number GR72 when you call.

In-Warranty Service (USA): For an appliance covered under the warranty period, no charge is made for service or postage. Call for return authorization (1 800 937-3883).

Out-of-Warranty Service: A flat rate charge by model is made for out-of-warranty service. Include \$20.00 (U.S.) for return shipping and handling. We will notify you by mail of the amount of the charge for service and require you to pay in advance for the repair or replacement.

For Products Purchased in the USA, but Used in Canada: You may return the product insured, packaged with sufficient protection, and postage and insurance prepaid to the USA address listed below. Please note that all customs duty / brokerage fees, if any, must be paid by you and we will require you to pay the cost of customs duty / brokerage fees to us in advance of our performing any service.

Risk During Shipment: We cannot assume responsibility for loss or damage during incoming shipment. For your protection, carefully package the product for shipment and insure it with the carrier. Be sure to enclose the following items with your appliance: any accessories related to your problem, your full return address and daytime phone number, a note describing the problem you experienced, a copy of your sales receipt or other proof of purchase to determine warranty status. C.O.D. shipments cannot be accepted.

To return the appliance, ship to:

Attn: Repair Center
Salton, Inc.
708 South Missouri Street
Macon, MO 63552

To contact us, please write to, call, or email:

Salton, Inc.
P.O. Box 1526
Columbia, MO 65205-1526
1(800) 937-3883
Email: Salton@Saltonusa.com

Limitation of Remedies: No representative or person is authorized to assume for Salton, Inc. any other liability in connection with the sale of our products. There shall be no claims for defects or failure of performance or product failure under any theory of tort, contract or commercial law including, but not limited to negligence, gross negligence, strict liability, breach of warranty and breach of contract. Repair, replacement or refund shall be the sole remedy of the purchaser under this warranty, and **in no event shall Salton be liable for any incidental or consequential damages, losses or expenses.** Some states do not allow the exclusion or limitation of incidental or consequential damages, so the above limitation or exclusion may not apply to you.

Legal Rights: This warranty gives you specific legal rights, and you may also have other rights which vary from state to state.

George Foreman™ is a trademark of Salton, Inc.

For more information on Salton products: Visit our website: <http://www.eSalton.com>

© 2002 Salton, Inc.
All Rights Reserved™

P/N 61165
Printed in China