

2-slice toaster

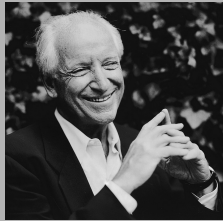

Michael Graves

The highly acclaimed work of designer Michael Graves has restored a sense of humanity to modern architecture. Graves, one of the most noted architects of our time, has designed buildings for such clients as Disney™ including the company's corporate headquarters and the Walt Disney™ World Swan and Dolphin Hotels. Gifted in design at every scale, Michael Graves has created products for the home that carry labels such as Alessi, FAO Schwarz, and Steuben. His work has been recognized with scores of awards. Most recently Michael Graves was selected for the 2001 American Institute of Architects Gold Medal award, the highest honor given by the AIA to an individual. In 1999, President Clinton presented Michael Graves with the National Medal of Arts.

The Michael Graves Collection provides an inspired balance of form and function. Sensible and sublime, practical and whimsical, the objects envisioned by this world-renowned architect infuse our daily lives with joy.



2-slice toaster

owner's manual

SAVE THIS USE AND CARE BOOK



 **BLACK & DECKER**

Please call 1-800-231-9786 with questions.

IMPORTANT SAFEGUARDS

When using electrical appliances, basic safety precautions should always be followed, including the following:

- **Please read all instructions.**
- Do not touch hot surfaces. Use handles or knobs.
- To protect against electrical shock, do not immerse cord, plug, or any non-removable parts of this toaster in water or other liquid.
- Close supervision is necessary when any appliance is used by or near children.
- Unplug from outlet when not in use and before cleaning. Allow to cool before cleaning.
- Do not operate any appliance with a damaged cord or plug or after the appliance malfunctions or is dropped or damaged in any manner. Return the appliance to the nearest authorized service facility for examination, repair, or electrical or mechanical adjustment. Or, call the toll-free number listed on the cover of this manual.
- The use of accessory attachments not recommended by the appliance manufacturer may cause injuries.
- Do not use outdoors.
- Do not let cord hang over edge of table or counter or touch hot surfaces.
- Do not place on or near a hot gas or electric burner or in a heated oven.
- To use, plug cord into electrical outlet. To disconnect, grasp plug and remove from outlet. Do not pull by the cord.
- Do not use toaster for other than intended use.
- Oversized foods, metal foil packages, or utensils must not be inserted in a toaster, as they may create a fire or risk of electric shock.
- A fire may occur if the toaster is covered or touching flammable material, including curtains, draperies, walls and the like, when in operation. Keep this appliance at least one inch away from walls or the rear of a counter. Do not store any item on top of unit when in operation.
- Do not attempt to dislodge food when toaster is plugged in.
- Do not operate in the presence of explosive and/or flammable fumes.
- This appliance is intended for household use only, not for commercial or industrial use. Use for anything other than intended will void the warranty.

SAVE THESE INSTRUCTIONS

POLARIZED PLUG

This appliance has a polarized plug — one blade is wider than the other. To reduce the risk of electric shock, this plug will fit into a polarized outlet only one way. If the plug does not fit fully into the outlet, reverse it. If it still does not fit, contact a qualified electrician. Do not attempt to defeat this safety feature by modifying the plug in any way.

ELECTRICAL CORD

The cord of this appliance was selected to reduce the possibility of tangling in or tripping over a longer cord. If more length is needed, use an Underwriters Laboratories (UL)-Listed extension cord rated no less than 15-amperes and 120 volts. When using an extension cord, do not let it drape over the working area or dangle where someone could accidentally trip over it. Handle cord carefully for longer life; avoid jerking or straining it at outlet and appliance connections.

SOFT-TOUCH PARTS

NOTE: The rubberized parts are free of natural rubber and latex. They are safe for use by individuals allergic or sensitive to these materials.

TOASTER PARTS

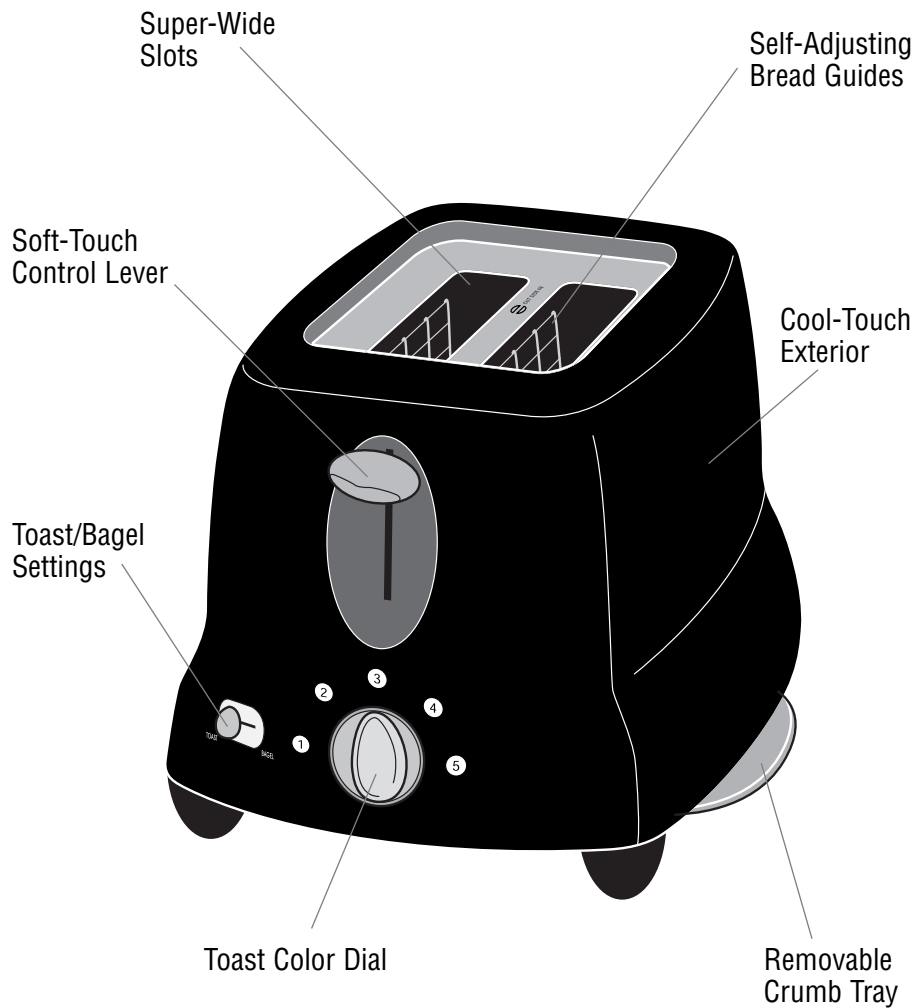

HOW TO USE

1. Plug the cord into a standard electrical outlet.

2. **SETTINGS:** Slide the lever to Toast or Bagel to choose your setting. When using the “Bagel” setting, place the cut side in (A) to toast the doughy inside of Bagels and English Muffins without over-crisping/browning the outside. For most toaster foods, such as bread, waffles, tarts, etc. use the Toast setting.

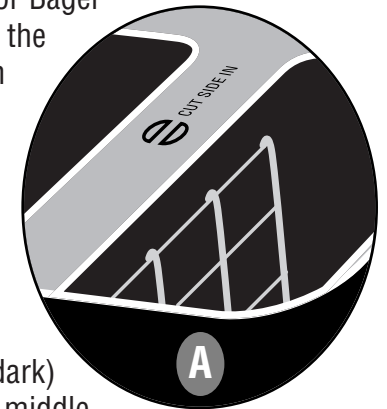

3. Adjust the Toast Color Dial to the desired setting from 1 (light) to 5 (dark) (B). For first use, set the Dial to the middle position 3. Adjust for lighter or darker toasting to suit your taste.

NOTE: For thin-sliced breads, toaster pastries, and packaged greasy toaster foods (such as those with sugary toppings), use lower settings and follow manufacturer’s instructions to avoid causing them to catch fire.

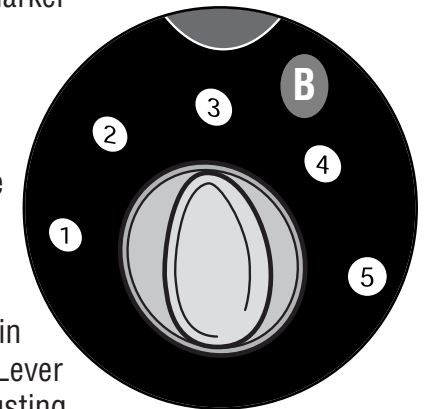

4. Place bread slices/toaster foods in the slots, and press the Control Lever down until it clicks. The self-adjusting bread guides will automatically adjust to hold thick or thin slices in place.

5. If food becomes wedged, unplug the cord from the outlet and move the Control Lever up and down a few times to raise “jammed” food. Never use metal utensils to free food.

6. To interrupt toasting at any time, simply lift the Control Lever up.

CARE AND CLEANING GUIDE

Always unplug the cord from the electrical outlet and allow the toaster to cool before cleaning. **DO NOT IMMERSER THE TOASTER IN WATER.**

CRUMB TRAY

1. Grasp the handle at the side of the toaster and pull the removable Crumb Tray completely out of the unit (C).
2. Dispose of crumbs and wash the Tray in hot, sudsy water. You can remove stubborn spots with a nylon mesh pad.
3. Be sure to dry thoroughly before slipping the Tray back into the Toaster.

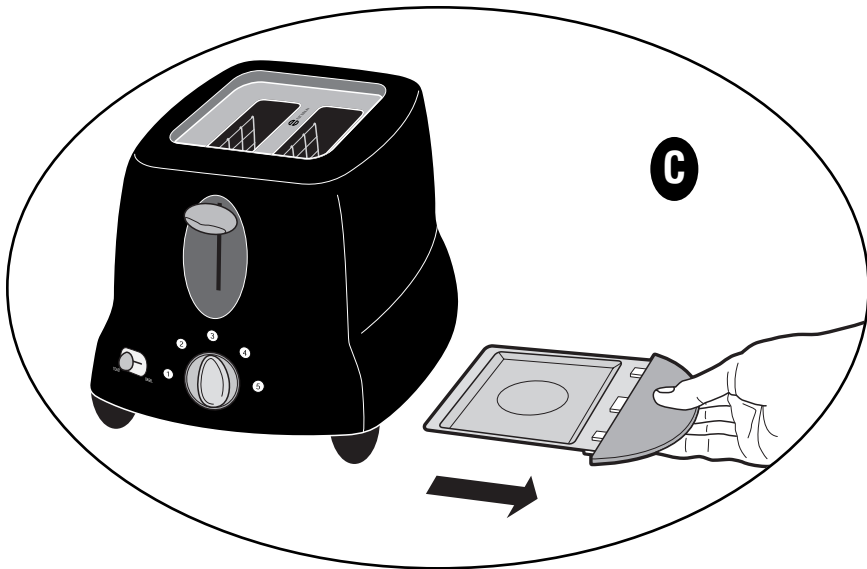

CLEANING THE OUTSIDE SURFACES

The cool-touch exterior won't burn your hand if accidentally touched. However, allow the toaster to cool completely before cleaning. Wipe the exterior with a damp cloth or sponge and dry with a paper towel. Do not use strong cleaners or abrasives that may scratch surfaces and never spray cleaners directly onto the toaster.

NEED HELP?

For service, repair, or any questions regarding your appliance, call the "800" number on the cover of this book. Do NOT return the product to the place of purchase. Do NOT mail the product back to the manufacturer nor bring it to a service center.

FULL ONE-YEAR WARRANTY

Applica warrants this product against any defects that are due to faulty material or workmanship for a one-year period after the original date of consumer purchase. This warranty does not include damage to the product resulting from accident, misuse, or repairs performed by unauthorized personnel. If the product should become defective within the warranty period, or you have questions regarding warranty or service, call Consumer Assistance and Information toll free at: 1-800-231-9786. This warranty gives you specific legal rights and you may also have other rights which vary from state to state or province to province.



Listed by Underwriters Laboratories, Inc.
Copyright © 2001 Applica Consumer Products, Inc.
Pub. No.177188-00-RV00
Printed in People's Republic of China

* **BLACK&DECKER** is a trademark of The Black & Decker Corporation, Towson, Maryland, U.S.A.